

混合式步进电机规格书

HYBRID STEPPING MOTOR SPECIFICATION

外形图 (DIMENSIONS) unit=mm

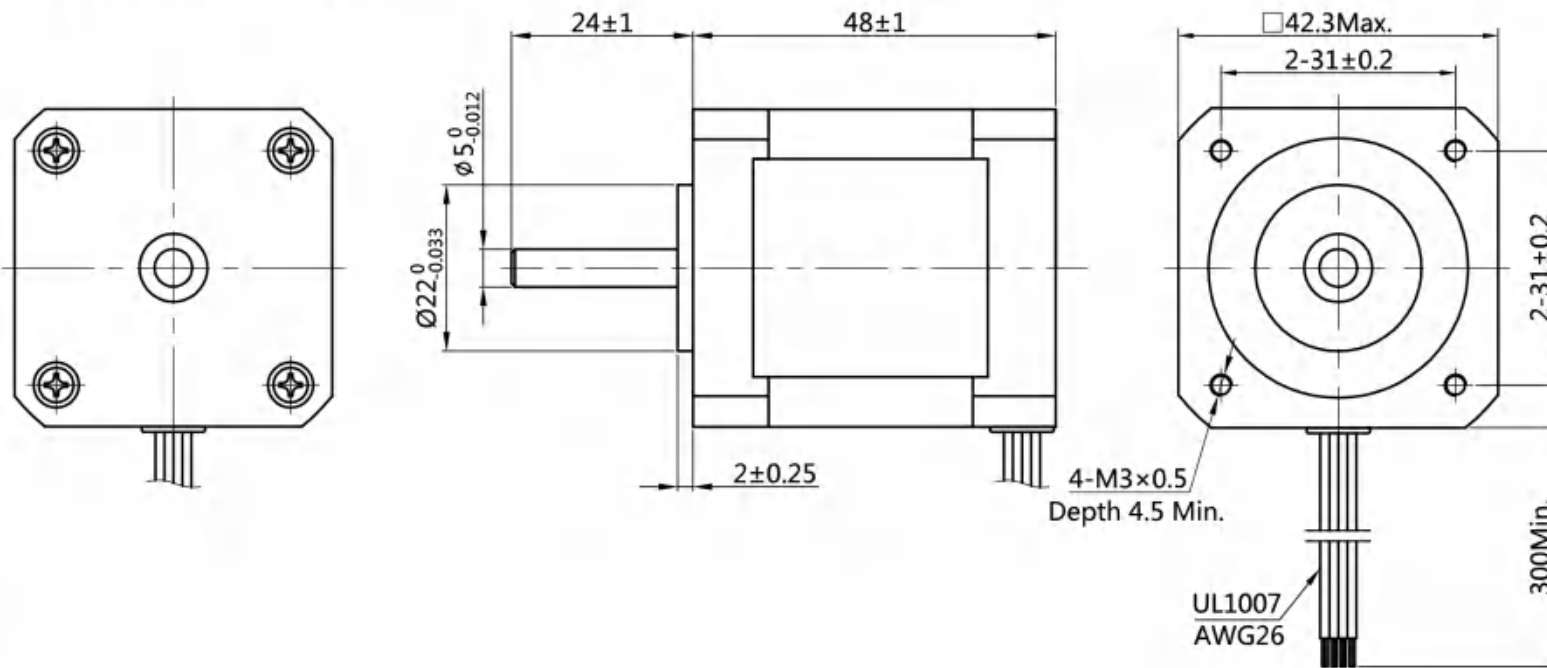

电气原理图

Wiring Diagram

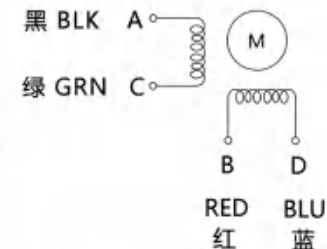

励磁顺序vs.旋转方向

Exciting Sequence vs. Direction of Rotation

| STEP | A | B | C | D | |
|------|---|---|---|---|-----|
| 1 | + | + | - | - | CCW |
| 2 | - | + | + | - | ↑ |
| 3 | - | - | + | + | |
| 4 | + | - | - | + | |
| | | | | | |

从安装面看为顺时针方向

Clockwise view from mounting side

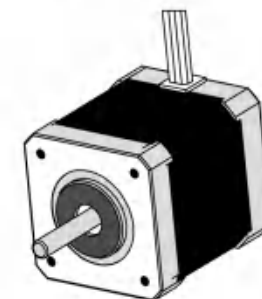

| | | | | | |
|------------------------------|-------------------------|-------------------|--|--|--|
| 1、相数 Number of Phase | 2 | | | | |
| 2、步距角 Step Angle | 0.9° deg. | | | | |
| 3、额定电压 Rated Voltage | 2.8 V | | | | |
| 4、额定电流/相 Rated Current/Phase | 1.68 A (峰值 Peak Value) | | | | |
| 5、相电阻 Phase Resistance | 1.65 Ω±0.1(20°C) | | | | |
| 6、相电感 Phase Inductance | 4.1 mH±20%(1kHz 1V RMS) | | | | |
| 7、保持力矩 Holding Torque | 4.4 kg.cm | | | | |
| 8、绝缘等级 Insulation Class | B (130°);温升 80K Max. | | | | |
| 9、重量 Weight | 0.34 kg | | | | |
| 规格 Specifications | | 备注 Comment | | | |

| 版本 REV. | 变更内容 REVISION RECORD | | 日期 DATE |
|---------------|----------------------|-----------|---------------------------------|
| 设计 DESIGN | 成兆茹 | 2020.6.29 | Changzhou BesFoc Motor Co., Ltd |
| 标准化 STANDARD | | | www.besfoc.com |
| 工艺 TECHNOLOGY | | | 规格书 Specification |
| 审核 CHECK | | | |
| 批准 APPROVE | | | |

| | | | |
|-------------|---------------------|----------|--------------------|
| 品名 TITLE | 步进电机 STEPPING MOTOR | | |
| 图号 DWG.NO. | BF42HM48-1684 | | |
| 材料 MATERIAL | | SIZE | A4 |
| 版本 REV. | A | 比例 SCALE | 1:1 页 SHEET 1 of 1 |