

Dimension:  
Unit=mm

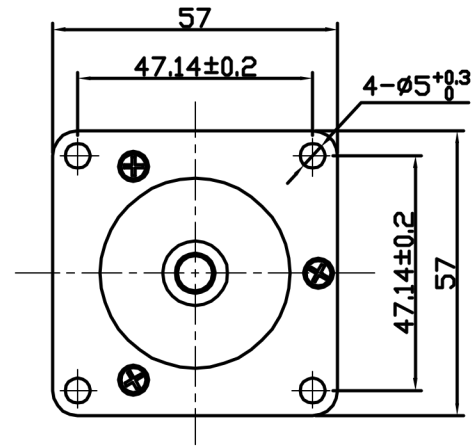
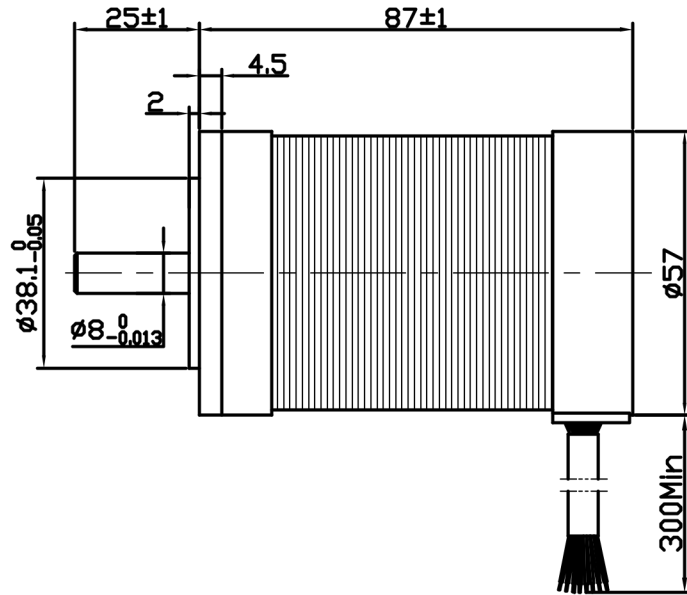

ROTATION: CCW SEE FROM LEAD END

MANUFACTURER MODEL	JK57BLF03
NUMBER OF POLES	4
PHASE TO PHASE RESISTANCE	0.6 OHMS
NOMINAL VOLTAGE	36 VDC
NO LOAD SPEED	4800±10% RPM
NO LOAD CURRENT	0.7 Amps Max.
RATED TORQUE	0.33 N-m
RATED SPEED	4000±10% RPM
OUTPUT POWER	138 W
BACK EMF CONSTANT	7.5 V/kRPM
TORQUE CONSTANT	0.072 N-m/A
INSULATION CLASS	B

ELECTRICAL CONNECTION TABLE

+5V	RED	红	UL1007 26AWG
HALL U	YEL	黄	
HALL V	GRE	绿	
HALL W	BLU	蓝	
GND	GND	黑	
PHASE U	YEL	黄	UL1007 18AWG
PHASE V	GRE	绿	
PHASE W	BLU	蓝	

Connection diagram:

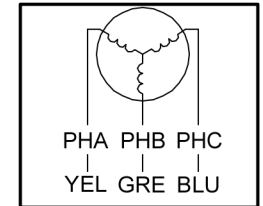
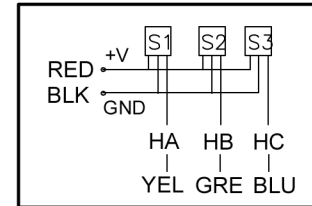

Hall sensor cable

Wiring cable

Note: hall sensor power supply voltage +5 to +20VDC

				Title:			Changzhou BesFoc Motor Co., Ltd		
				Specification					
REV.	QTY.	No.	SIG.	DATE	CLS.MAK		WEIGHT	SCALE	BF57BLF03
DESIGN	H/W	16.11.28	STD.						
CHECK									www.besfoc.com
PROC.				APPR.			PAGE: 1/1		